

Cooler: Cosmetal River AF15/25/5050 G62/61

Construction

These floor mounted water coolers are grey painted with important parts in stainless steel.

It uses a direct chill cooling system with stainless steel coil which guarantees maximum hygiene and no stagnant water.

All AF models have front access. The front of the fountain has a removable panel which can be easily unlocked and opened for maintenance and replacement of filter cartridges.

Use

Combination mechanical pushbutton control jet and swan-neck tap.



Voltages:

220 -240V single phase 50 or 60Hz

Options:

Chlorine filter/purifier

Stainless steel. (only AF 25/AF50)

Overflow safety valve (only AF 25/AF50)

Water pressure reducing valve

Capacity:

AF15 – 15 L/Hour

AF25 – 25 L/Hour

AF50 – 50 L/Hour

- EASY CLEANING
- ENERGY EFFICIENT
- HIGH CAPACITY
- COMPACT DESIGN
- RECYCLABLE



05.11

TECHNICAL SPECIFICATION

Dwg: 300082
Date: 2011.06.24

| Voltage | Rated Power | Current | Weight |
|----------|-------------|---------|--------|
| 230/1/60 | 0,15kW | 0,65A | 27kg |

WATER COOLER
COSMETAL RIVER 15 G62/61

BACK VIEW

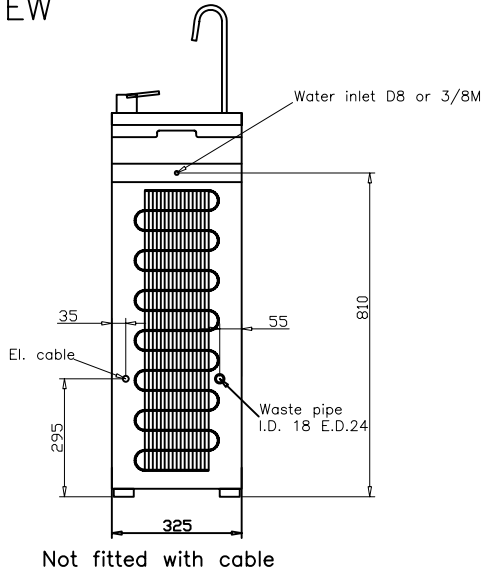

LEFT VIEW

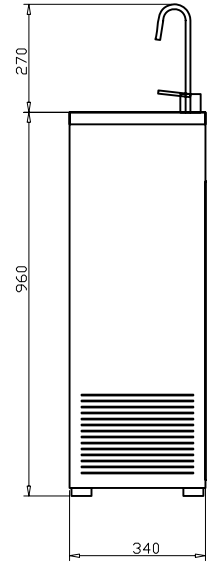

TOP VIEW

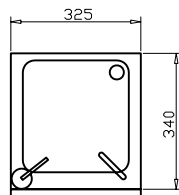

BOTTOM VIEW

